



## DS-1271ZJ-130

Pendent Mounting Bracket for  
Dome Camera

### Features:

- Aluminum alloy material with surface spray treatment
- Waterproof design
- Cable hole on bracket makes the feature better
- Design of cap is for convenient wiring

### Dimension:

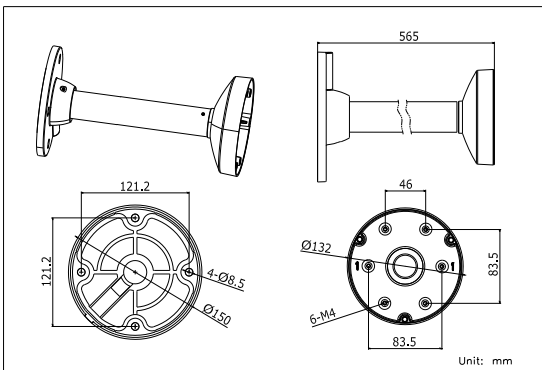

### Order Model:

DS-1271ZJ-130

### Parameter:

|            |  |
|------------|--|
| Model      | DS-1271ZJ-130                            |
| Parameters | Pendent Mounting Bracket for Dome Camera |
| Appearance | Hikvision White                          |
| Material   | Aluminum Alloy                           |
| Dimension  | Φ 150X565mm                              |
| Weight     | 1900g                                    |

### Notice:

- The bracket should be installed on flat wall
- The wall must be capable of supporting over 3 times as much as the total weight of the camera and the mount.
- The maximum load capacity of the bracket is 4.5KG

### Model Suitable:

DS-2CD7X3PF(NF)-E(I)(Z), DS-2CD793PFWD-E(I)(Z), DS-2CD793NFW-E(I)(Z), DS-2CD7X4FWD-E(I)(Z)  
DS-2CD7XXF-E(I)(Z), DS-2CD783F-EP, DS-2CD4112F-(I), DS-2CD4112FWD-(I), DS-2CD4124F-(I), DS-2CD4132FWD-(I)

### Installation Step:

- ① Choose the appropriate wall to install the ceiling plate and wiring

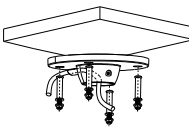

- ② Connect pole and adaptor cap; wiring and screw up

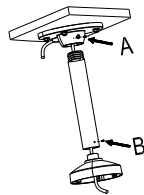

A & B: Fastening screw

- ③ Screw up in A & B and fix pendent pole and cap

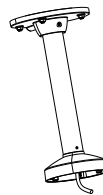

- ④ Screw the dome to the cap

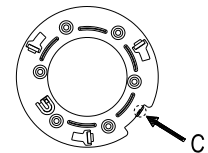

C: Bayonet of dome adaptor

- ⑤ Check the hole site and fix adaptor to cap

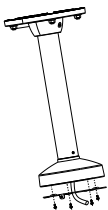

- ⑥ Wiring and fix dome camera to adaptor

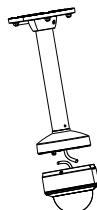

- ⑦ Rotate the dome camera moderately and screw up the fastening screw

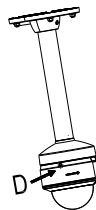

D: Fastening screw on dome

- ⑧ Installation complete

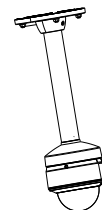

**Note:** The actual dome camera may vary from the picture above.